

Kiyose building(\*tentative name)

75 Million Yen

Gross Yield 7.32 %

\*when it's fully occupied

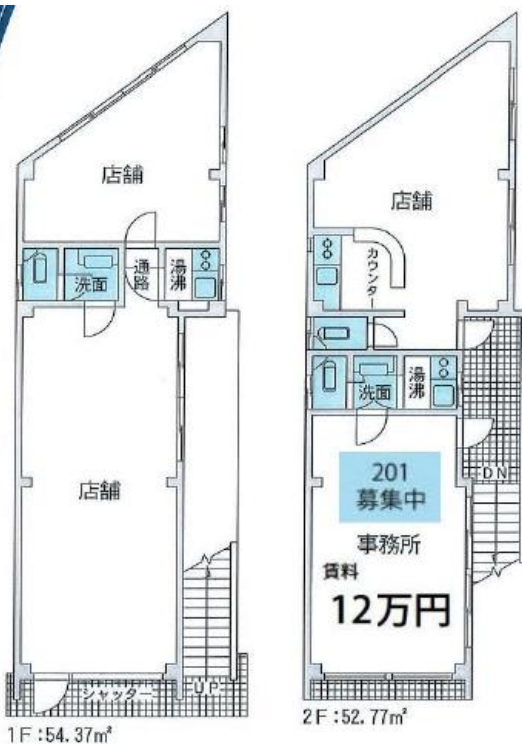

**Annual Rent Income(year)**

5,496,000 yen \*when it's fully occupied

**Location**

Tokyo Kiyose-city

<https://goo.gl/maps/ZCXYhsR7wf92>

**Access**

1 minutes' walk to Kiyose Station

**Structure**

Steel Frame

2 story above the ground and 0 story basement

**Year Built**

1985

**Unit #**

4 units

**Land Size**

83.19 sqm

**Building Size**

107.14 sqm

**Occupancy**

3 units Occupied

**Land Ownership**

Freehold

**Current Annual Rent Income & Gross Yield**

4,056,000 yen 5.40 %

**Building Cover Ratio / Floor Area Ratio**

80 % / 400 %

**Other**



3-6 4F Sakuragaoka-cho Shibuya, Tokyo

☎03-6452-5740

✉noguchi@godai-inc.com