

ToshinFenix Koenji quattro

18 Million Yen

Gross Yield 5.66 %

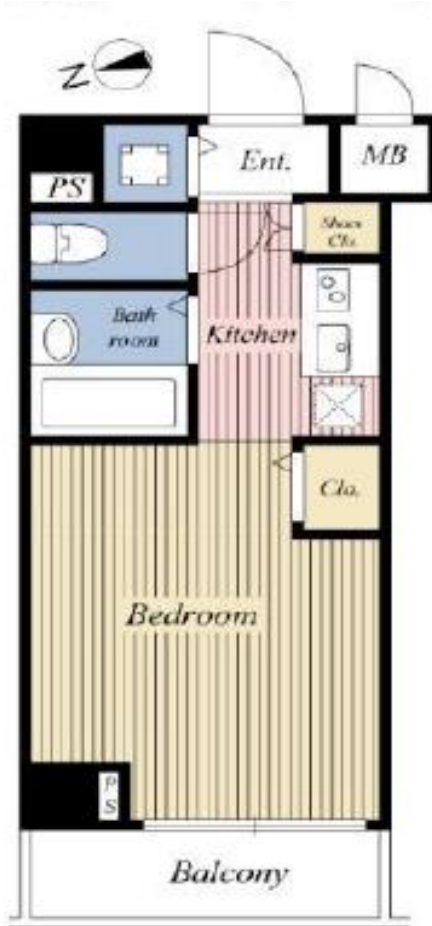

*If the drawings and the present situation is different, priority is given to current status.

トーシンフェニックス高円寺クアトロ



3-6 4F Sakuragaoka-cho Shibuya, Tokyo

☎03-6452-5740

✉noguchi@godai-inc.com

Annual Rent Income(year)

1,020,000 yen

Location

Tokyo Suginami-ku

<https://goo.gl/maps/sqtKiDpaXSU2>

Access

9 minutes' walk to Kouenji Station

Structure

Reinforced Concrete

11 story above the ground and 0 story basement

Year Built

2006

Room (Floor)

2 F

Size

20.52 sqm

Layout

Studio Type

Occupancy

Rented

Land Ownership

Freehold

Maintenance Fee

10,000 yen / month

Repair Fund

3,650 yen / month

Other

Total Units: 25 Facing: West